

# *aliiix 50x1 and 50x3*

## Single and Triple Reciprocating Syringe Pumps

The aliiix pump is an adjustable reciprocating syringe pump with metal-free flow paths that rapidly and reproducibly dispenses liquids.

### Benefits

- High speed
  - ✓ Dispenses up to 2,500 (aliiix 50x1) and 7,500 (aliiix 50x3) times per hour
  - ✓ Adjustable dispensing rate
- High repeatability
  - ✓ Reproducibility from  $\pm 0.2\%$  to  $\pm 0.7\%$  depending on volume dispensed and speed
- Versatility
  - ✓ Dispense from one to three outlets simultaneously (aliiix 50x3)
  - ✓ Different liquids can be pumped separately without mixing (aliiix 50x3)
- Rugged
  - ✓ PTFE-coated steel rotary mechanism provides strength and corrosion resistance
- Low maintenance
- Easy installation

### Features

- Dispensed volume is adjustable from  $< 1$  mL/cycle to  $> 40$  mL/cycle (using a 50 mL syringe)
- Up to 100,000 (aliiix 50x1) and 300,000 (aliiix 50x3) mL/hr
- Metal-free flow path
- Dual fluoropolymer check valves
- Foot switch for remote operation (aliiix 50x1)
- Handheld triple sample dispenser (aliiix 50x3)



aliiix 50x1 single reciprocating pump with foot switch for hands-free actuation of the pump



aliiix 50x3 triple reciprocating syringe pump with handheld sample dispenser

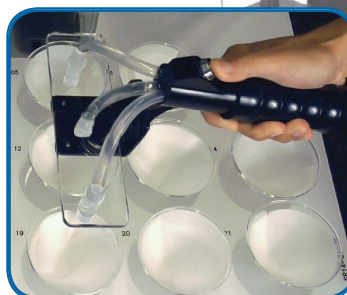

## Power Requirements

The aliix pump requires a main supply of 100-120V or 200-230V +/- 10%, 50-60Hz, output: 90W. The unit should be located within 2m of a power outlet.

## Space Requirements

Dimensions are approximately 26cm x 48cm x 28cm (10.2" x 18.9" x 10.8") (WxHxD). A minimum clearance of 15cm (6") is recommended on the left side of the unit for the syringe mechanism.

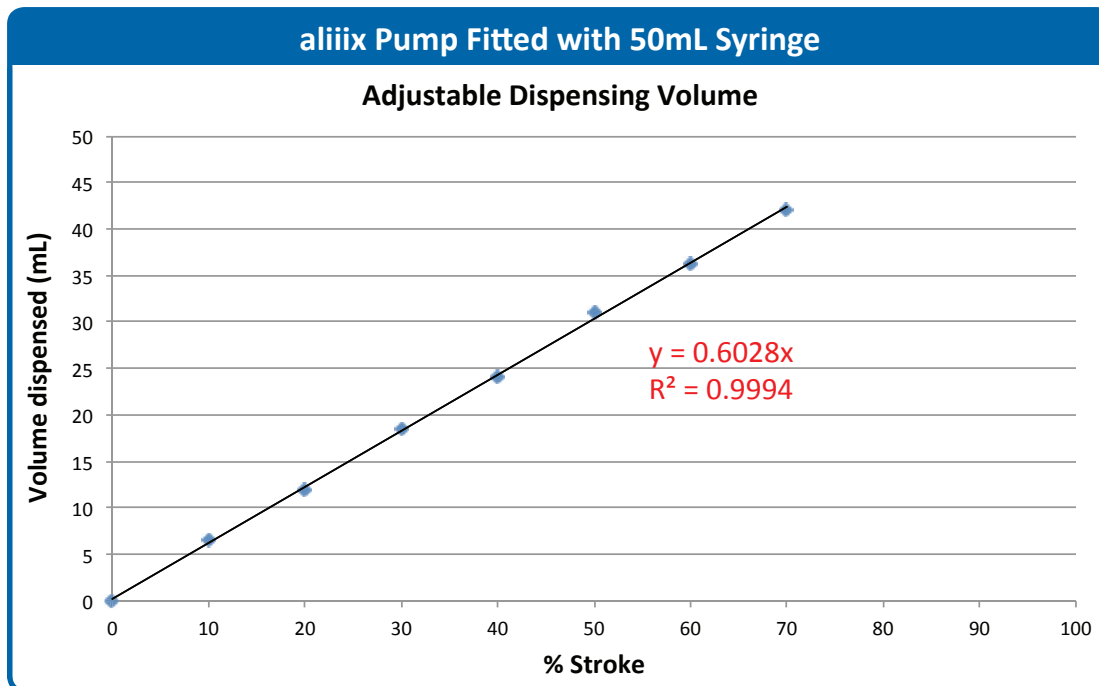

Figure 1. Volume dispensed increases linearly with plunger setting and is easily adjustable.

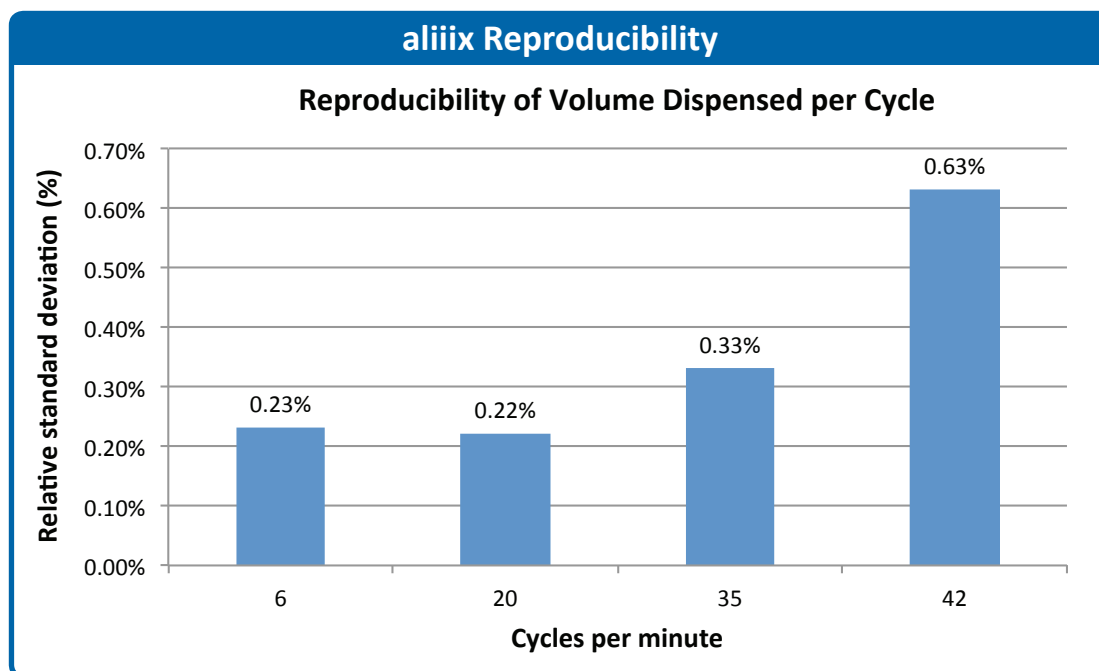
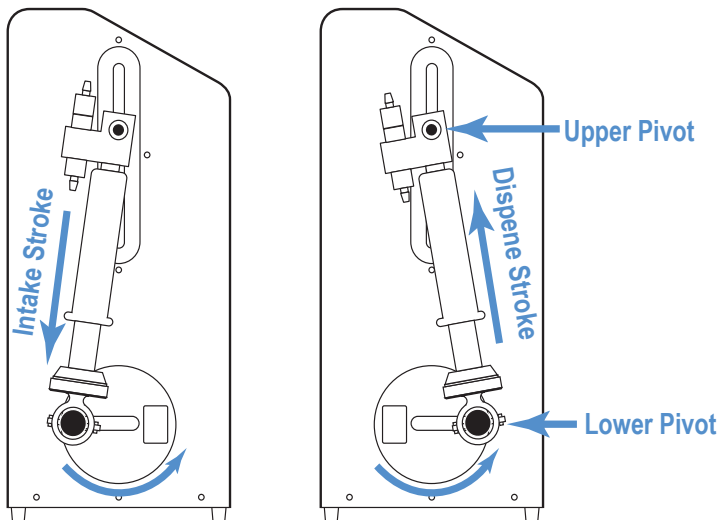
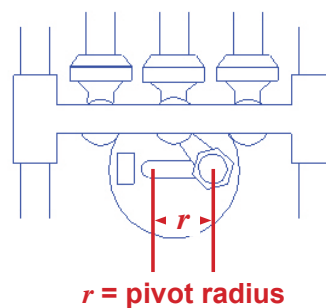
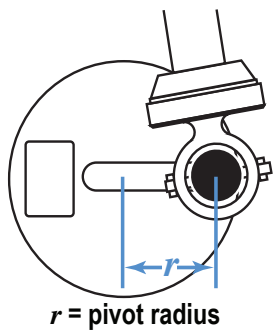
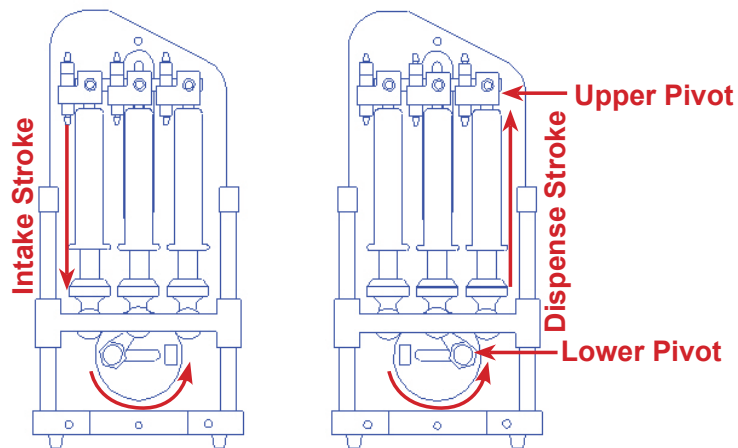

Figure 2. Effect of delivery speed on precision. 25mL dispensed each time from each syringe.

aliiix 50x1



aliiix 50x3



**Figure 3.** Pump cycle consists of an intake stroke and a dispense stroke. Volume dispensed is adjusted using a thumb wheel to vary the pivot radius.

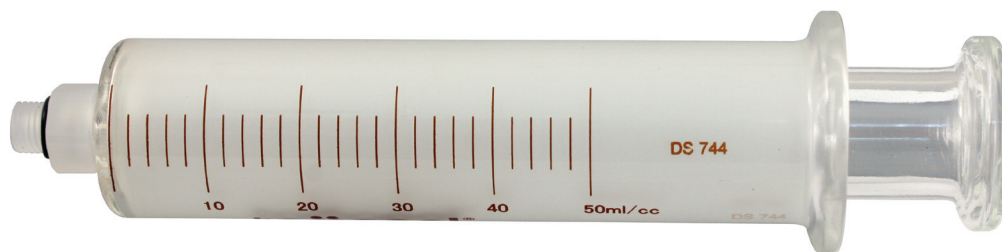

**Figure 4.** The aliiix pump includes a 50mL glass syringe. Please contact ESI for other syringe sizes.

## Options



**Figure 5.** The aliix 50x1 pump comes with a remote foot switch for dispensing samples.



**Figure 6.** The aliix 50x3 pump comes with a handheld triple sample dispenser for variable spacing and multiple sample dispensing.

Part Number	Description
aliix-50x1-A	110-120V reciprocating syringe pump
aliix-50x1-B	200-230V reciprocating syringe pump
aliix-50x3-A	110-120V reciprocating triple syringe pump
aliix-50x3-B	200-230V reciprocating triple syringe pump
AP-1008	aliix 50x3 handheld triple sample dispenser
AP-1005	Foot switch for dispensing pump
AP-1010	Spare 50mL syringe



7277 World Communications Drive | Omaha, NE 68122  
 Phone: 1.402.991.7800  
 Email: sales@icpms.com  
 Web: www.icpms.com